

# Shear off screw connectors - know no bounds

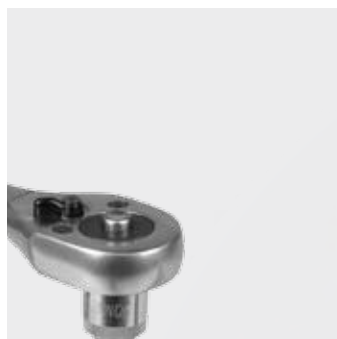

**Tightening under  
control**



**Optimal  
tightening of wire**



**Easy, fast and  
reliable assembly**



**Wide range of  
application**

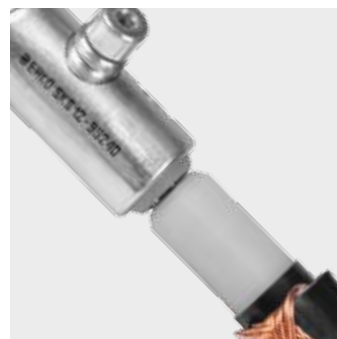

## **ALTERNATIVE FOR CRIMPING TECHNOLOGY**

The principle of technology are shear off head screws enabling universal and fast application. The special feature is possibility of applying one connector for conductors of different structure and wide cross section range.

## SZS Shear off screw connector

up to 36 kV

Material: aluminum. Standard: tinned.

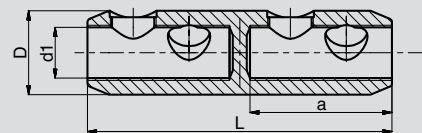

| Symbol     | Al conductor cross section [mm <sup>2</sup> ] |         |         |         |         | Cu [mm <sup>2</sup> ] |         |         | Dimensions [mm] |      |     |    | Allen wrench / Ring spanner | Number of screws |
|------------|---|---------|---------|---------|---------|-----------------------|---------|---------|-----------------|------|-----|----|-----------------------------|------------------|
|            | rm  | re      | sm      | se      | rmv     | rm                    | sm      | rmv     | d <sub>1</sub>  | D    | L   | a  |                             |                  |
| SZS 1695   | 16-70   | 16-95   | 25-70   | 16-95   | 16-95   | 16-70                 | 25-70   | 16-95   | 13              | 25,5 | 70  | 32 | 6 / -                       | 2                |
| SZS 50150  | 50-120  | 50-150  | 50-120  | 50-150  | 50-150  | 50-120                | 50-120  | 50-150  | 15,5            | 30   | 85  | 35 | 6 / -                       | 2                |
| SZS 95240  | 95-185  | 95-240  | 95-185  | 95-240  | 95-240  | 95-185                | 95-185  | 95-240  | 20              | 33   | 120 | 56 | 6 / -                       | 4                |
| SZS 120300 | 120-300                                       | 120-300 | 120-240 | 120-300 | 120-300 | 120-300               | 120-240 | 120-300 | 25              | 38   | 142 | 67 | 8 / -                       | 4                |

## SKS Shear off screw terminal

up to 36 kV

Material: aluminum. Standard: tinned.

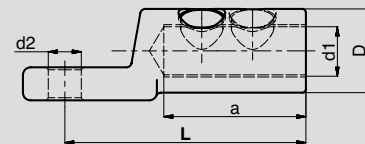

| Symbol        | Al conductor cross section [mm <sup>2</sup> ] |         |         |         |         | Cu [mm <sup>2</sup> ] |         |         | Dimensions [mm] |                |    |     |    | Allen wrench / Ring spanner | Number of screws |
|---------------|---|---------|---------|---------|---------|-----------------------|---------|---------|-----------------|----------------|----|-----|----|-----------------------------|------------------|
|               | rm  | re      | sm      | se      | rmv     | rm                    | sm      | rmv     | d <sub>2</sub>  | d <sub>1</sub> | D  | L   | a  |                             |                  |
| SKS 12-1695   | 16-70   | 16-95   | 25-70   | 16-95   | 16-95   | 16-70                 | 25-70   | 16-95   | 13              | 12,5           | 24 | 60  | 32 | 6 / -                       | 1                |
| SKS 12-50150  | 50-120  | 50-150  | 50-120  | 50-150  | 50-150  | 50-120                | 50-120  | 50-150  | 13              | 15,5           | 30 | 79  | 35 | 6 / -                       | 1                |
| SKS 16-50150  | 50-120  | 50-150  | 50-120  | 50-150  | 50-150  | 50-120                | 50-120  | 50-150  | 17              | 15,5           | 30 | 79  | 35 | 6 / -                       | 1                |
| SKS 12-95240  | 95-185  | 95-240  | 95-185  | 95-240  | 95-240  | 95-185                | 95-185  | 95-240  | 13              | 20             | 33 | 95  | 56 | 6 / -                       | 2                |
| SKS 16-95240  | 95-185  | 95-240  | 95-185  | 95-240  | 95-240  | 95-185                | 95-185  | 95-240  | 17              | 20             | 33 | 95  | 56 | 6 / -                       | 2                |
| SKS 12-120300 | 120-300                                       | 120-300 | 120-240 | 120-300 | 120-300 | 120-300               | 120-240 | 120-300 | 13              | 25             | 38 | 100 | 67 | 8 / -                       | 2                |
| SKS 16-120300 | 120-300                                       | 120-300 | 120-240 | 120-300 | 120-300 | 120-300               | 120-240 | 120-300 | 17              | 25             | 38 | 100 | 67 | 8 / -                       | 2                |

## SZN Shear off screw connector

up to 1 kV

Material: aluminum. Standard: non tinned. Available tinned.

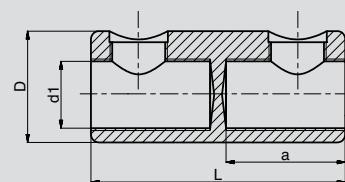

| Symbol       | Al conductor cross section [mm <sup>2</sup> ] |         |         |         | Cu [mm <sup>2</sup> ] |         |        | Dimensions [mm] |    |     |      | Allen wrench / Ring spanner | Number of screws |
|--------------|---|---------|---------|---------|-----------------------|---------|--------|-----------------|----|-----|------|-----------------------------|------------------|
|              | rm  | sm      | re      | se      | rm                    | sm      | re     | d <sub>1</sub>  | D  | L   | a    |                             |                  |
| SZN 1625-N   | 16-35   | 16-25   | 16-35   | 16-35   | 10-25                 | 10-25   | 10-25  | 9               | 18 | 40  | 18   | - / 10                      | 2                |
| SZN 1650-N   | 16-50   | 16-50   | 16-50   | 16-50   | 16-50                 | 16-50   | 16-50  | 11              | 21 | 55  | 25   | 6 / -                       | 2                |
| SZN 2595-N   | 25-95   | 25-95   | 25-95   | 25-95   | 25-95                 | 25-95   | 25-95  | 14              | 25 | 55  | 25   | 6 / -                       | 2                |
| SZN 25150-N  | 25-150  | 25-120  | 25-150  | 25-150  | 25-150                | 25-120  | 25-150 | 17,5            | 28 | 70  | 32,5 | 6 / -                       | 2                |
| SZN 25185-N  | 35-185  | 25-185  | 35-185  | 25-185  | 25-185                | 25-185  | 25-185 | 21              | 35 | 80  | 37,5 | 6 / -                       | 2                |
| SZN 120240-N | 120-240                                       | 120-185 | 120-240 | 120-240 | 120-240               | 120-240 | -      | 23              | 38 | 128 | 60   | 8 / -                       | 4                |

## SKN Shear off screw terminal

up to 6 kV

Material: aluminum. Standard: tinned.

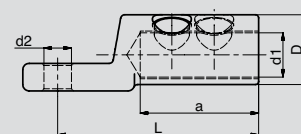

| Symbol        | Al conductor cross section [mm <sup>2</sup> ] |         |         |         | Cu [mm <sup>2</sup> ] |         |        | Dimensions [mm] |                |    |     |      | Allen wrench / Ring spanner | Number of screws |
|---------------|---|---------|---------|---------|-----------------------|---------|--------|-----------------|----------------|----|-----|------|-----------------------------|------------------|
|               | rm  | sm      | re      | se      | rm                    | sm      | re     | d <sub>2</sub>  | d <sub>1</sub> | D  | L   | a    |                             |                  |
| SKN 8-1625    | 16-35   | 16-25   | 16-35   | 16-35   | 10-25                 | 10-25   | 10-25  | 8,4             | 9              | 18 | 40  | 18   | - / 10                      | 1                |
| SKN 10-1625   |   |         |         |         |                       |         |        | 10,5            | 9              | 18 | 40  | 18   | - / 10                      | 1                |
| SKN 12-1625   |   |         |         |         |                       |         |        | 13              | 9              | 18 | 40  | 18   | - / 10                      | 1                |
| SKN 8-2595    | 25-95   | 25-95   | 25-95   | 25-95   | 25-95                 | 25-95   | 25-95  | 8,4             | 14             | 28 | 60  | 32,5 | 6 / -                       | 1                |
| SKN 10-2595   |   |         |         |         |                       |         |        | 10,5            | 14             | 28 | 60  | 32,5 | 6 / -                       | 1                |
| SKN 12-2595   |   |         |         |         |                       |         |        | 13              | 14             | 28 | 60  | 32,5 | 6 / -                       | 1                |
| SKN 8-25185   | 35-185  | 25-185  | 35-185  | 25-185  | 25-185                | 25-185  | 25-185 | 8,4             | 21             | 33 | 95  | 56   | 6 / -                       | 2                |
| SKN 10-25185  |   |         |         |         |                       |         |        | 10,5            | 21             | 33 | 95  | 56   | 6 / -                       | 2                |
| SKN 12-25185  |   |         |         |         |                       |         |        | 13              | 21             | 33 | 95  | 56   | 6 / -                       | 2                |
| SKN 8-120240  | 120-240                                       | 120-185 | 120-240 | 120-240 | 120-240               | 120-240 | -      | 8,4             | 23             | 38 | 100 | 63   | 8 / -                       | 2                |
| SKN 10-120240 |   |         |         |         |                       |         |        | 10,5            | 23             | 38 | 100 | 63   | 8 / -                       | 2                |
| SKN 12-120240 |   |         |         |         |                       |         |        | 13              | 23             | 38 | 100 | 63   | 8 / -                       | 2                |
| SKN 16-120240 |   |         |         |         |                       |         |        | 17              | 23             | 38 | 100 | 63   | 8 / -                       | 2                |