

## OPERATION MANUAL



### HEAD TYPE GR1

SWW 0792

#VGR1080728

PKWiU 29.56.25-90.00

**Producent / Producer / Производитель**

**Zakłady Metalowe ERKO R. Pętlak spółka jawna  
Bracia Pętlak**

**ul. Ks. Jana Hanowskiego 7, 11-042 JONKOWO k/OLSZTYNA**  
tel./fax (+48) 089 5129273 NIP: 739-020-46-93  
e-mail: sprzedaz@erko.pl, export@erko.pl [http\www.erko.pl](http://www.erko.pl).



**Dziękujemy za zakup naszego urządzenia.  
Prosimy o uważne przeczytanie instrukcji użytkowania oraz zaleceń eksploatacyjnych.**

**Thank you for buying our product.  
Before using this equipment, please carefully read the user and the maintenance manuals.**

**Благодарим за покупку нашего оборудования.  
Просим внимательно прочитать инструкцию пользователя, а также рекомендации по эксплуатации**

## TABLE OF CONTENTS

1.	APPLICATION .....	2
2.	TECHNICAL DATA .....	2
3.	INSTRUMENTATION .....	2
4.	OPERATION.....	2
5.	SPARE PARTS.....	3
6.	MAINTENANCE AND OPERATION RECOMMENDATIONS.....	4
7.	SERVICING .....	4
8.	DISPOSAL.....	4

\* Firma ERKO sp.j. zastrzega sobie prawo do wprowadzania zmian konstrukcyjnych wynikających z modernizacji wyrobów.

\* ERKO has the right to introduce construction modifications due to equipment modernization.

\* Фирма ERKO sp.j. оставляет за собой право для введения конструкционных изменений вытекающих из модернизации изделий.



**Before using this equipment, please read the user and the safety manuals.**

## 1. APPLICATION

It is designed for clamping REKIN® (R1, R2,R01) type adapters placed on enamelled and non-insulated winding pipes. It is equipped with SR type dies and PT type quick coupler. It is supplied in a metal box.

## 2. TECHNICAL DATA

Weight (without dies)	5.6 kg
Force	100.2 kN
Length	300 mm
Working pressure	630 bar

## 3. INSTRUMENTATION

The G1 head supports the following clamp dies:

- SR1 – for R1 adapter
- SR2 – for R2 adapter
- SR01– for R01 adapter

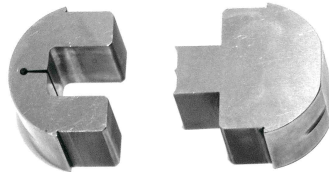

## 4. OPERATION

- a. Select an adequate adapter type for a specific pipe diameter.
- b. Use proper clamping dies for the selected type of adapter.
- c. Place the dies in the head.
- d. Place the adapter in the dies and fix by pre-clamping.
- e. Place the pipes into the adapter socket and clamp them until the maximum working pressure at the generator is attained.
- f. Press the “return” button on the control box.

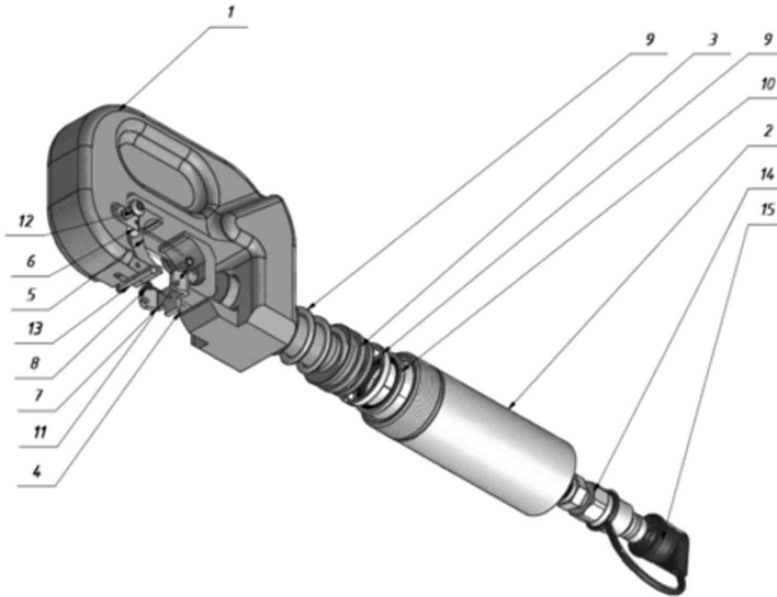
**5. SPARE PARTS**

No.	Quantity	Description	Drawing number / Standard number
1.	1	Body	GR1-01
2.	1	Cylinder	GR1-02
3.	1	Piston	GR1-03
4.	1	Lower insert	GR1-04-01
5.	1	Upper insert	GR1-05
6.	2	Insertion grip	GR1-08
7.	1	Securing device	GR1-10
8.	1	Insert spring	GR1-11
9.	1	Spring	GR1-00-06-A
10.	1	Guiding ring	HUTR_GP6500400-C380
11.	1	Sealing ring	HUTR_PSK200400-T46N
12.	1	Flat Head Socket Cap Screw	NEZS_VI-M6-20-10.9CZ
13.	2	Screw M6 x 10	NEZS_WKI-M6-10-10.9CZ
14.	1	Rivet	NEZT_R3-29,3-FE
15.	1	PT high pressure quick coupler	PT-00
16.	1	PT quick coupler shield M FIRG14	PT_OSLONA

## 6. MAINTENANCE AND OPERATION RECOMMENDATIONS

1. The following must be done before work is started:
  - a. check the technical condition of the head,
  - b. its proper connection with the pump
  - c. and the correctness of the clamping dies
2. **When powered by a hydraulic generator, it is forbidden to switch it on during completion of any maintenance (assembly and disassembly, setting the machined elements).**
3. **Switch the generator on only after making sure that the preparation has been finished and there is no danger of body harm.**
4. Do not pull out the clamp pusher with no clamping dies in the head.
5. Use adequate clamping dies for a given type of terminals and cord diameter.
6. Clamp terminals until the pump overflow valve activation.
7. Protect the equipment against the influence of atmospheric factors, corrosion, debris and mechanical damage. Store in a condition protected against any outside factors.
8. The quick coupler should be maintained clean to prevent debris from entering the circulation and damaging the pump, supporting equipment or the quick couplers.
9. The work should be done in appropriate protective clothing, with individual protective devices.
10. When doing the work, do not put any items into the working space, other than those for which the tool is intended.
11. The tightness of the die inserts and the cylinder should be checked periodically.
12. Exercise caution while working.
13. After the work has been completed, make sure that the oil has been drained from the system. The machine must not be left under load.
14. The machine must not be used when defective or suspected to be defective, until the defect has been removed.

## 7. SERVICING

ERKO provides full service both during and after the guarantee period.

## 8. DISPOSAL

After the end of the exploitation period, utilize or recycle the particular elements of this equipment according to the environment protection regulations in force.